

W e . s u p p o r t . t h e
i n n o v a t i o n s . o f . c u s t o m e r s

Leak - Proof Flow & Control Solution Partner

The Best Partner
for Value Creation

Instrument Pipe Fittings

HanSun

한선엔지니어링(주)
HANSUN ENGINEERING CO., LTD.



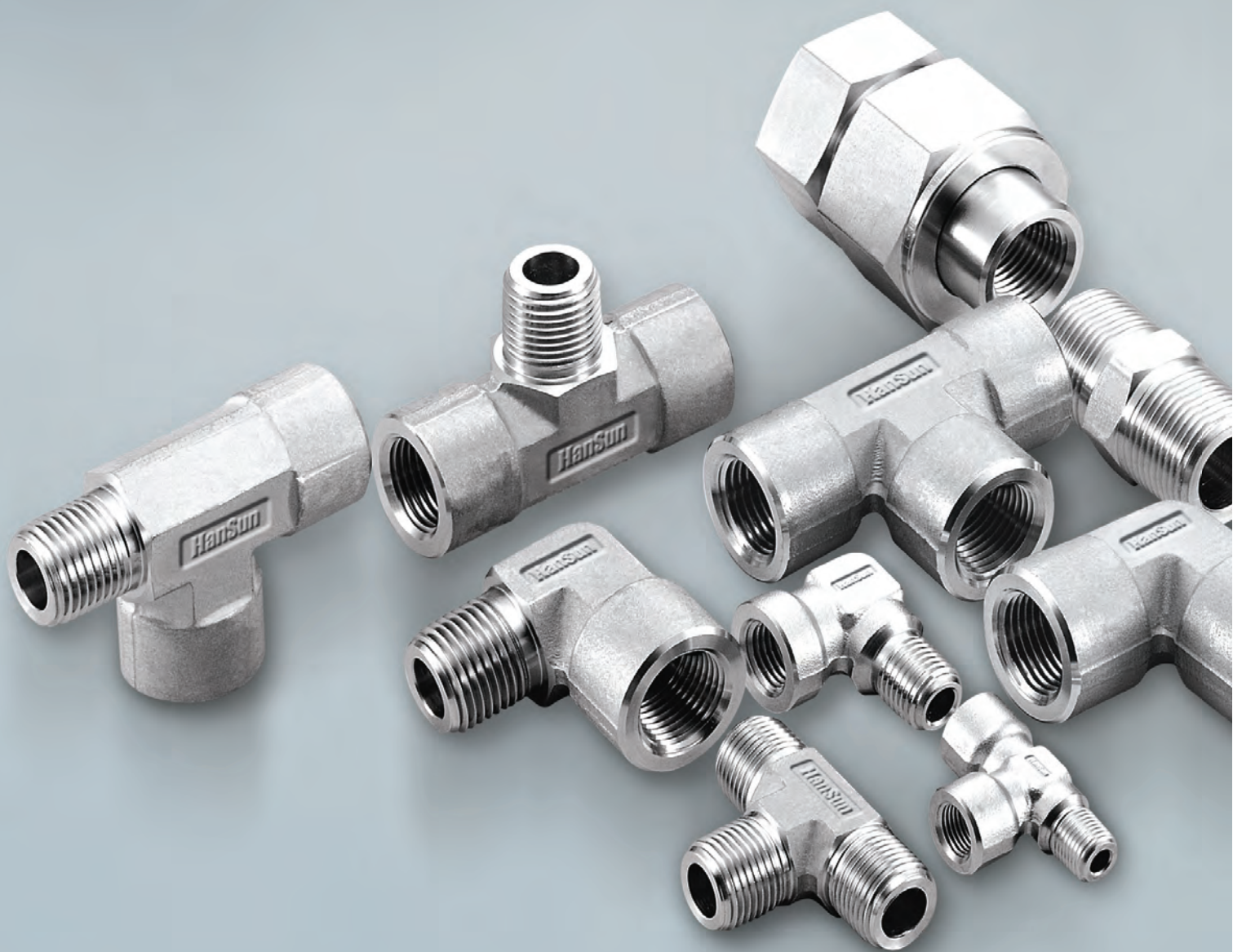



Certificate List



API Spec.Q1



API Monogram



ABS



Lloyd's



DNV



GL



BV



KR



NK



CCS



Gost - R



ECE RIIO / ISO / 5500 / NGV 3.1 / CSA 12.3

Features

- All instrument thread fittings are designed in accordance with ASME B31.3 for instrument and process.
- Male thread are protected with cap.
- Burr-free internal and outside surfaces.
- NPT threads are based on requirement of ASME B1.20.1

Material Standards & Temperature Ratings

Material	Bar Stock	Forgings	Temperature
SS316	ASTM A479 ASTM A276	ASTM A182	-325°F-1200°F (-198°C-648°C)
Brass	ASTM B16, ASTM B453	ASTM B283	-325°F-400°F (-198°C-204°C)
Carbon steel	ASTM A108 JIS G4051	JIS G4051	-20°F-350°F (-29°C-176°C)

Gasket and O-ring Temperature Ratings

Component	Material	Temperature Ratings
O-ring	Buna N	-13°F to 23°F of (-25°C to 110°C)
	FKM (Viton®)	-20°F to 400°F (-28°C to 204°C)
SCG	Copper	-325°F to 400°F (-198°C to 204°C)
SBG	Buna N	-13°F to 230°F (-25°C to 100°C)
	FKM(Viton®)	5°F to 400°F (-15°C to 204°C)
Thread sealant teflon tape		-320°F to 450°F (-196°C to 232°C)

Pressure Ratings

Size Designator	NPT Size	316 Stainless Steel				Brass				Carbon steel			
		Male		Female		Male		Female		Male		Female	
		psig	bar	psig	bar	psig	bar	psig	bar	psig	bar	psig	bar
1	1/16	11,000	757	6,700	416	5,500	378	3,300	227	11,000	757	6,700	461
2	1/8	10,000	689	6,500	447	5,000	344	3,200	220	10,000	689	6,500	447
4	1/4	8,000	551	6,600	454	4,000	275	3,300	227	8,000	551	6,600	454
6	3/8	7,800	537	5,300	365	3,900	268	2,600	179	7,800	537	5,300	365
8	1/2	7,700	530	4,900	337	3,800	261	2,400	165	7,700	530	4,900	337
12	3/4	7,300	502	4,600	316	3,600	248	2,300	158	7,300	502	4,600	316
16	1	5,300	365	4,400	303	2,600	179	2,200	151	5,300	365	4,400	303
20	1 1/4	6,000	413	5,000	344	3,000	206	2,500	172	6,000	413	5,000	344
24	1 1/2	5,000	344	4,600	316	2,500	172	2,300	158	5,000	344	4,600	316
30	2	3,900	268	3,900	268	1,900	130	1,900	130	3,900	268	3,900	268

- Pressure ratings listed are for temperature up to 37.8C (100°F).
- Based on Pressure Pipe Code ASME B31.3 pressure rating is calculated with an allowable stress value of 20,000psi SS316, 10,000psi, brass 20,000psi, carbon Steel.
- To determine the working pressure in accordance with Power Pipe Code ASME B31.1, multiply psig by 0.94.
- Brass pressure ratings remain the same.
- Due to larger outer diameter of female threads rating of female are lower than male threads.
- To determine kPa rating, multiply psig by 6.89.
- Reducing Hex Bushing (P-SHB) pressure rating is not covered in this table. See the pressure rating in the dimensional data chart.

Ordering Information

Material	S.Steel 316	S.Steel 316L	Carbon Steel	Brass
Identifier	S6	6L	CS	BS

• Example: P - SHN - 8N - S6

Pipe fitting ———— Material
Name of fitting ———— Pipe thread Size

Pipe Thread Symbol & Designator

Pipe Size	Designator	NPT	ISO Thread	
			Tapered (7/1)	Parallel (228/1)
1/8	2	2N	2R	2G
1/4	4	4N	4R	4G
3/8	6	6N	6R	6G
1/2	8	8N	8R	8G
3/4	12	12N	12R	12G
1	16	16N	16R	16G

P-SCN
 Close Nipple
 (Male NPT both ends)

06

P-SHN
 Hex Nipple
 (Male NPT both ends)

06

P-SHRN
 Hex Reducing Nipple
 (Male NPT to reduced male NPT)

06

P-SHN
 Hex Nipple
 (Male NPT to ISO tapered)

06

P-SHN
 Hex Nipple
 (Male NPT to male ISO parallel)

07

P-SHLN
 Hex Long Nipple
 (Male NPT both ends)

07

P-MFAA
 Adapter
 (Female NPT to male NPT)

07

P-MFRA
 Reducing Adapter
 (Female NPT to reduced male NPT)

07

P-MFAA
 Adapter
 (Female NPT to male ISO tapered)

08

P-MFAB
 Adapter
 (Female NPT to male ISO parallel)

08

P-SHB
 Reducing Hex Bushing
 (Male NPT to reduced female NPT)

08

P-SC
 Pipe Cap
 (Female NPT)

09

P-SP
 Pipe Plug
 (Male NPT)

09

P-SHC
 Hex Coupling
 (Female NPT both ends)

09

P-SHRC
 Hex Reducing Coupling
 (Female NPT to reduced female NPT)

09

P-SL
 Elbow
 (Female NPT both ends)

10

P-SSL
 Street Elbow
 (Female to male NPT)

10

P-SRSL
 Reducing Street Elbow
 (Female to male NPT)

10

P-SML
 Male Elbow
 (Male NPT both ends)

10

P-ST
 Tee
 (Female NPT)

11

P-SRT
 Run Tee
 (Female to male to female NPT)

11

P-SBT
 Branch Tee
 (Female to male to male NPT)

11

P-SMT
 Male Tee
 (Male NPT)

11

P-SUJ
 Union Ball Joint
 (Female NPT both ends)

11

SCG
 Iso Parallel Gasket
 11

P-SWFC
 Union
 13

P-SWL
 Union Elbow

13

P-SWT
 Union Tee
 (Female NPT both ends)

13

P-SWMC
 Male Connector

13

P-SWFCN
 Female Connector

13

P-SWML
 Male Elbow

13

P-SWFL
 Female Elbow

14

P-SWRM
 Pipe Weld to Tube
 Socket Weld

14

P-SWRM
 Tube Weld to Tube
 Socket Weld

14

P-SCN

Close Nipple

(Male NPT both ends)

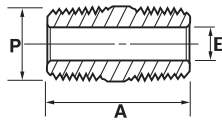

Part Number	P Pipe Size	A	E
P-SCN- 2N	1/8	19.05	4.8
P-SCN- 4N	1/4	28.4	7.1
P-SCN- 6N	3/8	28.4	9.6
P-SCN- 8N	1/2	31.7	11.9
P-SCN-12N	3/4	31.7	15.7
P-SCN-16N	1	47.8	22.4

P-SHN

Hex Nipple

(Male NPT both ends)

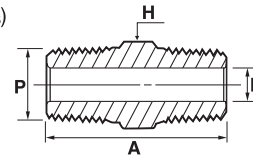

Part Number	P Pipe Size	A	E	H Hex
P-SHN- 2N	1/8	25.4	4.8	11.1
P-SHN- 4N	1/4	35.3	7.1	14.2
P-SHN- 6N	3/8	36.1	9.6	17.4
P-SHN- 8N	1/2	46.7	11.9	22.2
P-SHN-12N	3/4	46.7	15.7	26.9
P-SHN-16N	1	58.7	22.3	34.9

P-SHRN

Hex Reducing Nipple

(Male NPT to reduced male NPT)

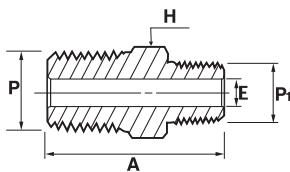

Part Number	P Pipe Size	P1 Reduced Pipe Size	A	E	H Hex
P-SHRN- 4-2N	1/4	1/8	30.7	4.8	14.2
P-SHRN- 6-2N	3/8	1/8	32.0	4.8	17.4
P-SHRN- 6-4N	3/8	1/4	36.1	7.1	17.4
P-SHRN- 8-2N	1/2	1/8	37.2	4.8	22.2
P-SHRN- 8-4N	1/2	1/4	41.7	7.1	22.2
P-SHRN- 8-6N	1/2	3/8	41.7	9.6	22.2
P-SHRN-12-4N	3/4	1/4	41.7	7.1	26.9
P-SHRN-12-8N	3/4	1/2	46.7	11.9	26.9
P-SHRN-16-4N	1	1/4	49.3	7.1	34.9
P-SHRN-16-8N	1	1/2	54.1	11.9	34.9

P-SHN

Hex Nipple

(Male NPT to ISO tapered)

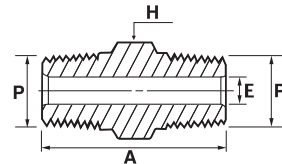

Part Number	P NPT Thread Size	P1 BSP/ISO Thread Size	A	E	H Hex
P-SHN- 2NR	1/8	1/8-28 7/1	24.6	4.1	11.1
P-SHN- 4NR	1/4	1/4-19 7/1	35.6	6.4	14.2
P-SHN- 6NR	3/8	3/8-19 7/1	36.3	9.7	17.4
P-SHN- 8NR	1/2	1/2-14 7/1	46	11.9	22.2
P-SHN-12NR	3/4	3/4-14 7/1	46.7	15.7	26.9
P-SHN-16NR	1	1-11 7/1	58.9	22.4	34.9

P-SHN

Hex Nipple

(Male NPT to male parallel)

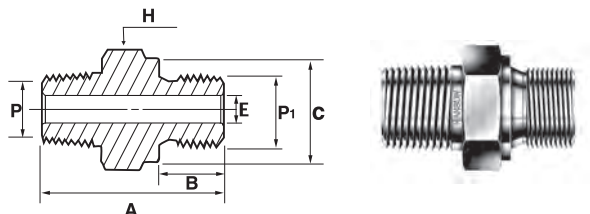

Part Number	P NPT Thread Size	P1 BSP/ISO Thread Size	A	B	C	E	H Hex
P-SHN - 2NG	1/8	1/8-28 228/1	27.4	7.1	13.7	4.1	14.2
P-SHN - 4NG	1/4	1/4-19 228/1	36.8	11.2	17.8	5.8	19.05
P-SHN - 6NG	3/8	3/8-19 228/1	37.6	11.2	21.8	7.9	22.2
P-SHN - 8NG	1/2	1/2-14 228/1	45.0	14.2	26.1	11.9	26.9
P-SHN-12NG	3/4	3/4-14 228/1	49.0	15.7	31.5	15.7	33.3
P-SHN-16NG	1	1-11 228/1	56.9	18.3	38.9	19.8	41

P-MFAA

Adapter

(Female NPT to male NPT)

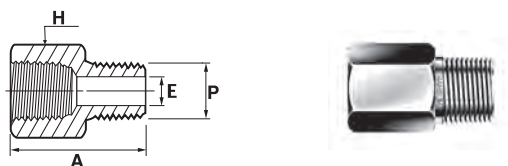

Part Number	P PipeSize	A	E	H Hex
P-MFAA - 2N	1/8	27.4	4.8	14.2
P-MFAA - 4N	1/4	35.6	7.1	19.05
P-MFAA - 6N	3/8	37.8	9.6	22.2
P-MFAA - 8N	1/2	49.0	11.9	26.9
P-MFAA -12N	3/4	50.3	15.7	31.7
P-MFAA -16N	1	58.0	22.3	41.2

P-SHLN

Hex Long Nipple

(Male NPT both ends)

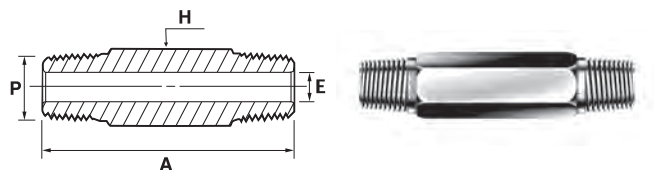

Part Number	P PipeSize	A	E	H Hex
P-SHLN - 2N	1/8	★	4.8	11.1
P-SHLN - 4N	1/4	★	7.1	14.2
P-SHLN - 6N	3/8	★	9.7	17.4
P-SHLN - 8N	1/2	★	11.9	22.2
P-SHLN -12N	3/4	★	15.7	26.9
P-SHLN -16N	1	★	22.4	34.9

★ : Configure to order

P-MFRA

Reducing Adapter

(Female NPT to reduced male NPT)

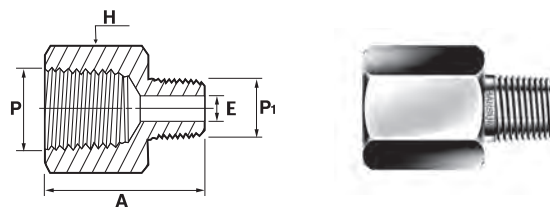

Part Number	P Female Pipe Size	P1 Male Pipe Size	A	E	H Hex
P-MFRA - 2 - 4N	1/4	1/8	31.5	4.8	19.05
P-MFRA - 2 - 6N	3/8	1/8	33.5	4.8	22.2
P-MFRA - 4 - 6N	3/8	1/4	37.8	7.1	22.2
P-MFRA - 2 - 8N	1/2	1/8	40.0	4.8	26.9
P-MFRA - 4 - 8N	1/2	1/4	44.5	7.1	26.9
P-MFRA - 6 - 8N	1/2	3/8	44.5	9.6	26.9
P-MFRA - 4-12N	3/4	1/4	45.7	7.1	31.8
P-MFRA - 6-12N	3/4	3/8	45.7	9.6	31.8
P-MFRA - 8-12N	3/4	1/2	51.1	11.9	31.8
P-MFRA - 4-16N	1	1/4	50.8	7.1	41.2
P-MFRA - 8-16N	1	1/2	54.9	11.9	41.2
P-MFRA -12-16N	1	3/4	55.1	15.7	41.2

P-MFAA

Adapter

(Female NPT to male ISO tapered)

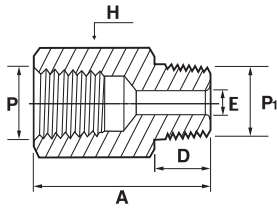

Part Number	P NPT Thread Size	P1 BSP/ISO Thread Size	A	D	E	H Hex
P-MFAA - 2RN	1/8	1/8-28 7/1	27.4	9.7	4.8	14.2
P-MFAA - 4RN	1/4	1/4-19 7/1	35.8	14.2	7.1	19.05
P-MFAA - 6RN	3/8	3/8-19 7/1	37.6	14.2	9.7	22.2
P-MFAA - 8RN	1/2	1/2-14 7/1	49.0	19.1	11.9	26.9
P-MFAA-12RN	3/4	3/4-14 7/1	50.3	19.1	15.7	31.8
P-MFAA-16RN	1	1-11 7/1	58.0	23.9	22.3	41.2

P-MFAB

Adapter

(Female NPT to male ISO parallel)

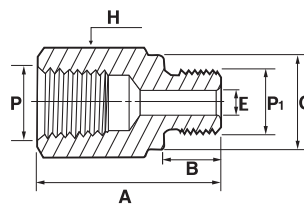

Part Number	P NPT Thread Size	P1 BSP/ISO Thread Size	A	B	C	E	H Hex
P-MFAB - 2GN	1/8	1/8-28 228/1	24.9	7.1	13.7	4.1	14.2
P-MFAB - 4GN	1/4	1/4-19 228/1	33.3	11.2	17.8	5.8	19.05
P-MFAB - 6GN	3/8	3/8-19 228/1	37.8	11.2	21.8	7.9	22.2
P-MFAB - 8GN	1/2	1/2-14 228/1	43.9	14.2	26.1	11.9	26.9
P-MFAB-12GN	3/4	3/4-14 228/1	50.8	15.7	31.5	15.7	33.3
P-MFAB-16GN	1	1-11 228/1	53.1	18.3	38.9	19.8	41.2

P-SHB

Reducing Hex Bushing

(Male NPT to reduced female NPT)

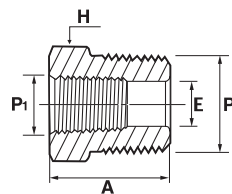

Part Number	P Male Pipe Size	P1 Female Pipe Size	A	E	H Hex	Working Pressure(PSIG)		
						316SS	Brass	Carbon Steel
P-SHB - 4 - 2N	1/4	1/8	26.7	7.1	14.2	5600	3100	6200
P-SHB - 6 - 2N	3/8	1/8	21.8	8.5	17.4			
P-SHB - 6 - 4N	3/8	1/4	30.0	9.6	19.05	5200	3100	6200
P-SHB - 8 - 2N	1/2	1/8	27.4	8.5	22.2	-	-	-
P-SHB - 8 - 4N	1/2	1/4	27.4	11.7	22.2	5800	3100	6200
P-SHB - 8 - 6N	1/2	3/8	35.6	11.9	22.2	4400	2500	5100
P-SHB -12 - 4N	3/4	1/4	27.4	11.4	26.9	-	-	-
P-SHB -12 - 6N	3/4	3/8	27.4	15.0	26.9	-	-	-
P-SHB -12 - 8N	3/4	1/2	41.4	15.7	26.9	-	-	-
P-SHB -16 - 4N	1	1/4	34.8	11.4	34.9	-	-	-
P-SHB -16 - 8N	1	1/2	34.8	18.5	34.9	-	-	-
P-SHB -16-12N	1	3/4	34.8	22.4	34.9	-	-	-

P-SC

Pipe Cap
(Female NPT)

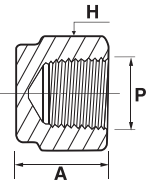

Part Number	P Pipe Size	A	H Hex
P-SC- 2N	1/8	19.1	14.2
P-SC- 4N	1/4	22.9	19.05
P-SC- 6N	3/8	26.2	22.2
P-SC- 8N	1/2	34.0	26.9
P-SC-12N	3/4	36.6	31.8
P-SC-16N	1	41.1	41.2

P-SP

Pipe Plug
(Male NPT)

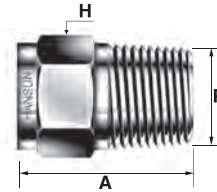

Part Number	P Pipe Size	A	H Hex
P-SP- 2N	1/8	19.05	11.1
P-SP- 4N	1/4	24.1	14.2
P-SP- 6N	3/8	25	17.4
P-SP- 8N	1/2	30.5	22.2
P-SP-12N	3/4	30.5	26.9
P-SP-16N	1	38.1	34.9

P-SHC

Hex Coupling
(Female NPT both ends)

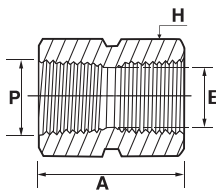

Part Number	P Pipe Size	A	E	H Wrench Flat
P-SHC- 2N	1/8	20.3	8.9	14.2
P-SHC- 4N	1/4	30.0	11.7	19.05
P-SHC- 6N	3/8	33.0	15.0	22.2
P-SHC- 8N	1/2	39.4	18.7	26.9
P-SHC-12N	3/4	41.0	23.5	31.8
P-SHC-16N	1	50.5	29.7	41.2

P-SHRC

Hex Reducing coupling
(Female NPT to reduced female NPT)

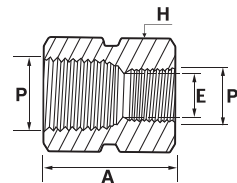

Part Number	P Pipe Size	P Reduced Pipe Size	A	E	H Hex
P-SHRC - 4 - 2N	1/4	1/8	31.2	8.9	19.05
P-SHRC - 6 - 4N	3/8	1/4	34.8	11.7	22.2
P-SHRC - 8 - 2N	1/2	1/8	39.4	8.7	26.9
P-SHRC - 8 - 4N	1/2	1/4	44.2	11.7	26.9
P-SHRC - 8 - 6N	1/2	3/8	45.0	15.0	26.9
P-SHRC-12 - 4N	3/4	1/4	45.7	11.7	31.8
P-SHRC-12 - 8N	3/4	1/2	52.0	18.7	31.8
P-SHRC-16 - 4N	1	1/4	50.8	11.7	41.2
P-SHRC-16 - 8N	1	1/2	55.4	18.7	41.2
P-SHRC-16-12N	1	3/4	57.0	23.5	41.2

P-SL

Elbow
(Female NPT both ends)

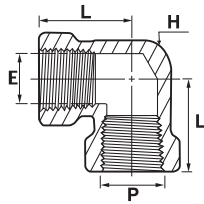

Part Number	P Pipe Size	L	E	H Wrench Flat
P-SL- 2N	1/8	24.1	8.9	12.7
P-SL- 4N	1/4	29.0	11.7	17.5
P-SL- 6N	3/8	34.5	15.0	20.6
P-SL- 8N	1/2	37.0	18.7	25.4
P-SL-12N	3/4	46.5	23.5	31.8
P-SL-16N	1	48.8	29.7	42.9

P-SSL

Street Elbow
(Female to male NPT)

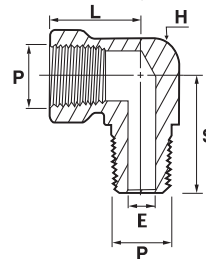

Part Number	P Pipe Size	L	S	E	H Wrench Flat
P-SSL- 2N	1/8	24.1	19.6	4.8	12.7
P-SSL- 4N	1/4	29.0	26.5	7.1	17.5
P-SSL- 6N	3/8	34.5	28.2	9.6	20.6
P-SSL- 8N	1/2	37.0	35.3	11.9	25.4
P-SSL-12N	3/4	46.5	39.6	15.7	31.8
P-SSL-16N	1	48.8	49.2	22.3	42.9

P-SRSL

Reducing Street Elbow
(Female to male NPT)

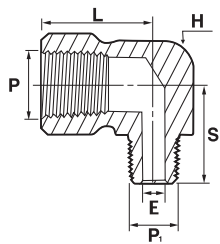

Part Number	P Pipe Size	P1 Male Pipe Size	L	S	E	H Wrench Flat
P-SRSL- 4-2N	1/4	1/8	29.0	22.4	4.8	17.5
P-SRSL- 6-4N	3/8	1/4	34.5	28.2	7.1	20.6
P-SRSL- 8-4N	1/2	1/4	37.0	30.5	7.1	25.4
P-SRSL- 8-6N	1/2	3/8	37.0	30.5	9.6	25.4
P-SRSL-12-8N	3/4	1/2	46.5	39.6	11.9	31.8
P-SRSL-16-8N	1	1/2	48.8	44.5	11.9	42.9

P-SML

Male Elbow
(Male NPT both ends)

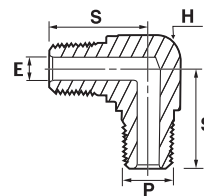

Part Number	P Pipe Size	S	E	H Wrench Flat
P-SML - 2N	1/8	19.05	4.8	12.7
P-SML - 4N	1/4	24.5	7.1	12.7
P-SML - 6N	3/8	26.9	9.6	17.5
P-SML - 8N	1/2	33.2	11.9	20.6
P-SML-12N	3/4	35.3	15.7	25.4
P-SML-16N	1	44.5	22.3	31.8

P-ST

Tee
(Female NPT)

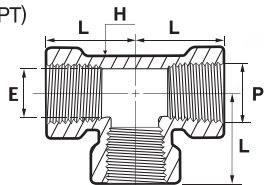

Part Number	P Pipe Size	L	E	H Wrench Flat
P-ST- 2N	1/8	24.1	8.9	12.7
P-ST- 4N	1/4	29.0	11.7	17.5
P-ST- 6N	3/8	34.5	15.0	20.6
P-ST- 8N	1/2	37.0	18.7	25.4
P-ST-12N	3/4	46.5	23.5	31.8
P-ST-16N	1	48.5	29.7	42.8

P-SBT

Branch Tee
(Female to Male to NPT)

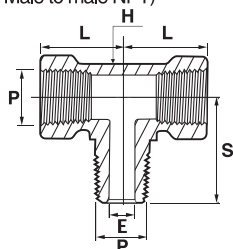

Part Number	P Pipe Size	L	S	E	H Wrench Flat
P-SBT- 2N	1/8	24.1	19.6	4.8	12.7
P-SBT- 4N	1/4	29.0	26.5	7.1	17.5
P-SBT- 6N	3/8	34.5	28.2	9.6	20.6
P-SBT- 8N	1/2	37.0	35.3	11.9	25.4
P-SBT-12N	3/4	46.5	39.6	15.7	31.8
P-SBT-16N	1	48.8	49.2	22.3	42.9

P-SUJ

Union Ball Joint
(Female NPT both ends)

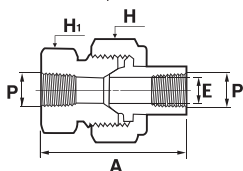

Part Number	P Pipe Size	A	E	H Hex	H ₁ Hex
P-SUJ-F- 2N	1/8	45.7	6.9	28.6	23.8
P-SUJ-F- 4N	1/4	59.4	9.1	34.9	30.2
P-SUJ-F- 6N	3/8	63.5	13.2	38.1	33.3
P-SUJ-F- 8N	1/2	68.6	15.7	44.5	41.3
P-SUJ-F-12N	3/4	79.2	22.4	50.8	47.6
P-SUJ-F-16N	1	90.4	26.2	63.5	60.3

P-SRT

Run Tee
(Female to male to Female NPT)

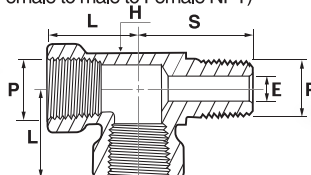

Part Number	P Pipe Size	L	S	E	H Wrench Flat
P-SRT- 2N	1/8	24.1	19.6	4.8	12.7
P-SRT- 4N	1/4	29.0	26.5	7.1	17.5
P-SRT- 6N	3/8	34.5	28.2	9.6	20.6
P-SRT- 8N	1/2	37.0	35.3	11.9	25.4
P-SRT-12N	3/4	46.5	39.6	15.7	31.8
P-SRT-16N	1	48.8	49.2	22.3	42.9

P-SMT

Male Tee
(Male NPT)

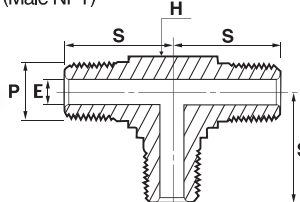

Part Number	P Pipe Size	S	E	H Wrench Flat
P-SMT- 2N	1/8	19.05	4.8	12.7
P-SMT- 4N	1/4	24.5	7.1	12.7
P-SMT- 6N	3/8	26.9	9.6	17.5
P-SMT- 8N	1/2	33.2	11.9	20.6
P-SMT-12N	3/4	35.3	15.7	25.4
P-SMT-16N	1	44.5	22.3	31.8

SCG

Iso Parallel Gasket

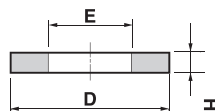

Part Number	P Pipe Size	E	H	D
SCG- 2N	1/8	10.0	2.0	18.0
SCG- 4N	1/4	14.0	2.0	22.0
SCG- 6N	3/8	17.0	2.0	26.0
SCG- 8N	1/2	22.0	2.0	32.0
SCG-12N	3/4	27.0	2.0	38.0
SCG-16N	1	34.0	2.0	42.0

HANSUN Instrument Weld Fittings

Features

- **HANSUN** instrument weld fittings are designed in accordance with ASME B16.11 welding connections.
- All socket weld ports have a tapered shape at the end that hold tubing properly and consistent alignment.
- Pressure ratings for weld fittings are in accordance with ANSI B31.3 and safety factor 4:1



HANSUN

P-SWFC

Union

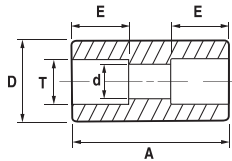

Part Number	T Tube O.D	d	D	E	A	Working psig	Pressure bar
P-SWFC- 4T	1/4	4.6	13.0	7.1	19.0	10,000	689
P-SWFC- 6T	3/8	7.1	15.8	7.9	22.4	7,600	523
P-SWFC- 8T	1/2	10.2	19.0	9.7	26.9	6,200	427
P-SWFC-10T	5/8	12.7	24.0	10.4	30.2	6,400	440
P-SWFC-12T	3/4	15.7	26.9	11.2	33.3	5,500	378
P-SWFC-16T	1	22.1	35.0	15.7	36.6	5,200	358

P-SWTA

Union Tee

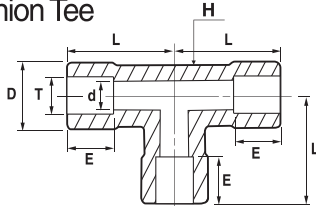

Part Number	T Tube O.D	d	D	E	H Wrench Flat	L	Working psig	Pressure bar
P-SWTA- 2T 1/8	2.3	13.4	2.5	12.7	15.0	11,800	813	
P-SWTA- 4T 1/4	4.6	13.4	7.1	12.7	21.8	11,300	778	
P-SWTA- 6T 3/8	7.1	15.8	7.9	12.7	24.5	8,400	578	
P-SWTA- 8T 1/2	10.2	20.6	9.7	17.4	29.0	7,800	537	
P-SWTA-10T 5/8	12.7	23.8	10.4	20.6	34.5	6,700	461	
P-SWTA-12T 3/4	15.7	28.6	11.2	25.4	37.0	6,700	461	
P-SWTA-16T 1	22.1	35.0	15.7	31.8	46.5	6,100	420	

P-SSB

Female Connector

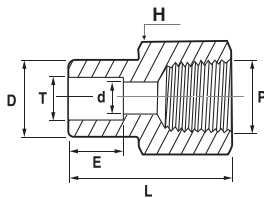

Part Number	T Tube O.D	P-NPT Female Pipe Size	d	D	E	H Hex	L	Working psig	Pressure bar
P-SSB- 2T-2N	1/8	1/8	2.3	7.4	2.5	14.2	21.1	6,100	420
P-SSB- 4T-2N	1/4	1/8	4.6	12.2	7.1	14.2	26.7	6,100	420
P-SSB- 4T-4N	1/4	1/4	4.6	12.2	7.1	19.05	30.0	6,200	427
P-SSB- 6T-4N	3/8	1/4	7.1	15.3	7.9	19.05	31.5	6,200	427
P-SSB- 8T-6N	1/2	3/8	10.2	18.5	9.7	22.2	34.5	5,000	344
P-SSB- 8T-8N	1/2	1/2	10.2	18.5	9.7	26.9	40.4	4,600	316
P-SSB-10T-8N	5/8	1/2	12.7	23.4	10.4	24.9	41.9	4,600	316
P-SSB-12T-12N	3/4	3/4	15.7	26.7	11.2	33.3	43.9	4,300	296

P-SWLA

Union Elbow

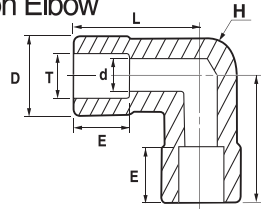

Part Number	T Tube O.D	d	D	E	H Wrench Flat	L	Working psig	Pressure bar
P-SWLA- 4T 1/4	4.6	13.4	7.1	12.7	21.8	11,300	778	
P-SWLA- 6T 3/8	7.1	15.8	7.9	12.7	24.5	8,400	578	
P-SWLA- 8T 1/2	10.2	20.6	9.7	17.4	29.0	7,800	537	
P-SWLA-10T 5/8	12.7	23.8	10.4	20.6	34.5	6,700	461	
P-SWLA-12T 3/4	15.7	28.6	11.2	25.4	37.0	6,700	461	
P-SWLA-16T 1	22.1	35.0	15.7	31.8	46.5	6,100	420	

P-SSA

Male Connector

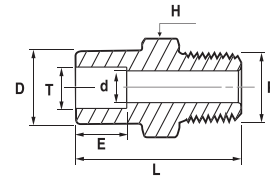

Part Number	T Tube O.D	P-NPT	d	D	E	H Hex	L	Working psig	Pressure bar
P-SSA-4T-2N	1/4	1/4	4.6	12.2	7.1	14.2	29.2	7,500	516
P-SSA-6T-4N	3/8	1/4	7.1	15.3	7.9	15.8	31.8	7,500	516
P-SSA-6T-6N	3/8	3/8	7.1	15.3	7.9	17.4	31.8	7,300	502
P-SSA-6T-8N	3/8	1/2	7.1	15.3	7.9	22.2	37.3	7,200	496
P-SSA-8T-4N	1/2	1/4	7.1	18.5	9.7	19.05	33.3	6,200	427
P-SSA-8T-6N	1/2	3/8	9.4	18.5	9.7	19.05	33.3	6,200	427
P-SSA-8T-8N	1/2	1/2	10.2	18.5	9.7	22.2	38.9	6,200	427

P-SMLSW

Male Elbow

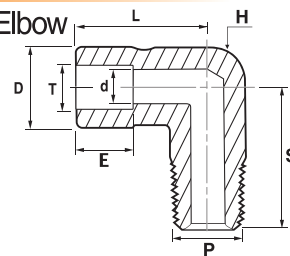

Part Number	T Tube O.D	P-NPT	d	D	E	H Wrench Flat	L	S	Working psig	Pressure bar
P-SMLSW - 4T-4N	1/4	1/4	4.6	15.8	7.1	12.7	20.1	24.5	7,500	516
P-SMLSW - 6T-4N	3/8	1/4	7.1	15.8	7.9	12.7	24.1	24.5	7,500	516
P-SMLSW - 6T-6N	3/8	3/8	7.1	20.6	7.9	17.4	24.6	29.0	7,300	502
P-SMLSW - 6T-8N	3/8	1/2	7.1	23.8	7.9	20.6	25.9	34.5	7,200	496
P-SMLSW - 8T-8N	1/2	1/2	10.2	23.8	9.7	20.6	27.4	34.5	6,200	427
P-SMLSW-12T-12N	3/4	3/4	15.7	28.6	11.2	25.4	37.0	37.0	6,700	461

P-SFLSW

Female Elbow

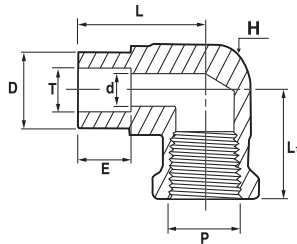

Part Number	T Tube O.D	P-NPT Female Pipe Size	d	D	E	H Wrench Flat	L	L1	Working psig	Pressure bar
P-SFLSW-4T-4N	1/4	1/4	4.6	12.2	7.1	17.4	22.9	29.7	6,200	427
P-SFLSW-6T-4N	3/8	1/4	7.1	15.3	7.9	17.4	25.1	29.7	7,000	482
P-SFLSW-6T-8N	3/8	1/2	7.1	15.3	7.9	25.4	28.7	37.0	5,400	372
P-SFLSW-8T-8N	1/2	1/2	10.2	18.5	9.7	25.4	30.2	37.0	5,400	372

P-SWRM

Pipe Weld to Tube Socket Weld

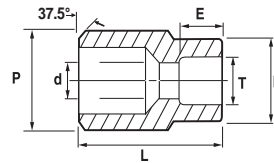

Part Number	P Pipe Size	T Tube Socket Size	d	D	E	L	Working psig	Pressure bar
P-SWRM-4P-4T	1/4	1/8	4.6	13.7	7.1	22.4	9,600	661
P-SWRM-6P-6T	3/8	3/8	7.1	15.3	7.9	26.2	7,600	523
P-SWRM-6P-8T	3/8	1/2	10.2	18.5	9.7	27.9	6,200	427
P-SWRM-8P-4T	1/2	1/4	4.6	12.2	7.1	28.4	7,300	502
P-SWRM-8P-6T	1/2	3/8	7.1	15.3	7.9	28.4	7,300	502
P-SWRM-8P-8T	1/2	1/2	10.2	18.5	9.7	30.2	6,200	427
P-SWRM-12P-6T	3/4	3/8	7.1	15.3	7.9	38.1	6,200	427
P-SWRM-12P-8T	3/4	1/2	10.2	18.5	9.7	38.1	6,200	427

P-SWRM

Tube Weld to Tube Socket Weld

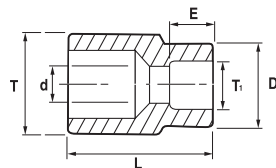

Part Number	T Tube O.D	T1 Tube Socket Size	d	D	E	L	Working Pressure psig	bar
P-SWRM - 4T - 2T	1/4	1/8	2.3	7.4	2.5	14.2	11,800	813
P-SWRM - 6T - 4T	3/8	1/4	4.6	12.2	7.1	19.1	7,700	530
P-SWRM - 8T - 4T	1/2	1/4	4.6	18.2	7.1	22.4	7,000	482
P-SWRM - 8T - 6T	1/2	3/8	8.1	15.7	7.9	22.4	7,000	482
P-SWRM - 12T - 8T	3/4	1/2	10.2	18.5	9.7	28.4	5,900	406
P-SWRM - 16T - 8T	1	1/2	10.2	18.5	9.7	35.1	5,600	344